

## INSTALLATION INSTRUCTIONS FOR **PDH-W**

**1**

Cable loop to ensure smooth open and closing. Allow sufficient slack on this section of cable

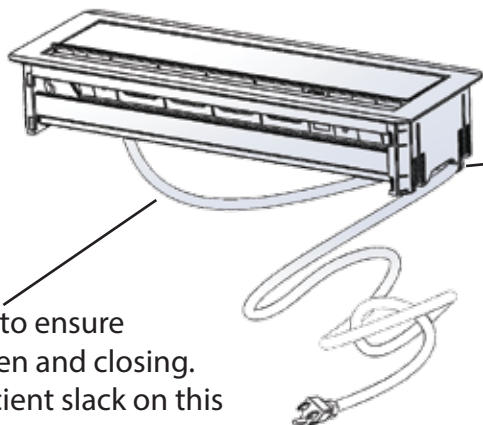
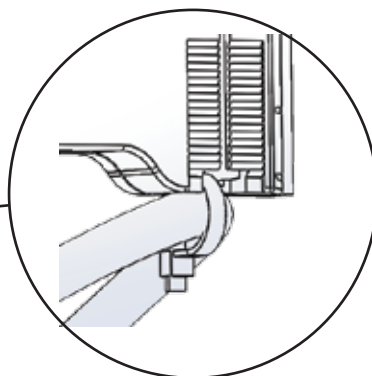

**Don't remove the cable tie**

*Tying the cable to the chassis prevents the unit from opening unexpectedly*

**2**

**Open the unit**

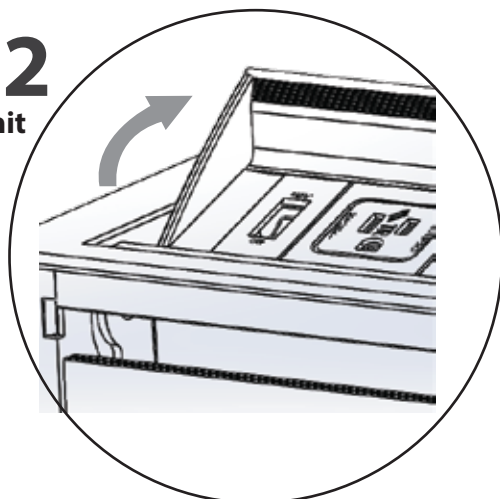
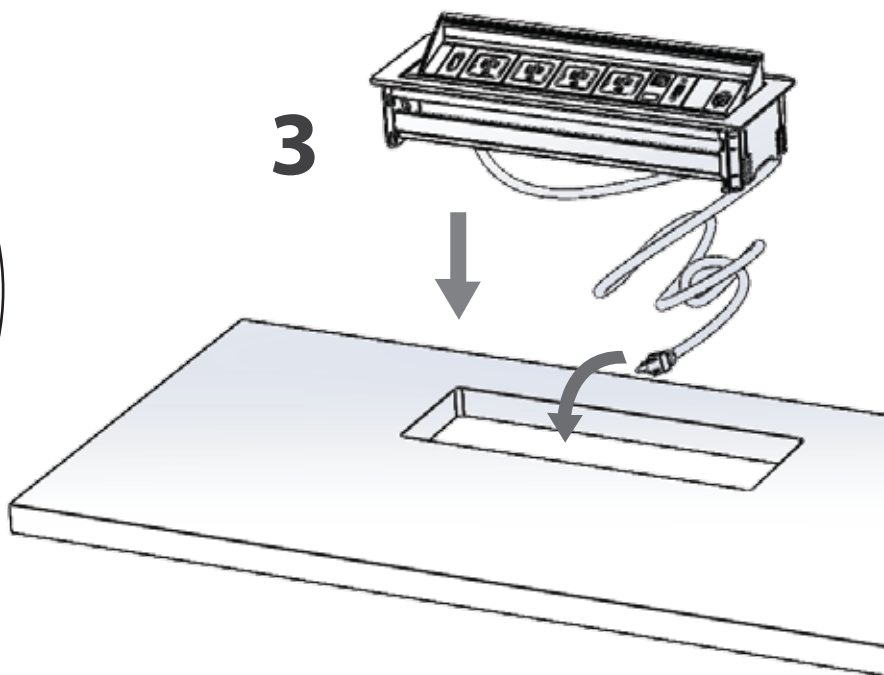
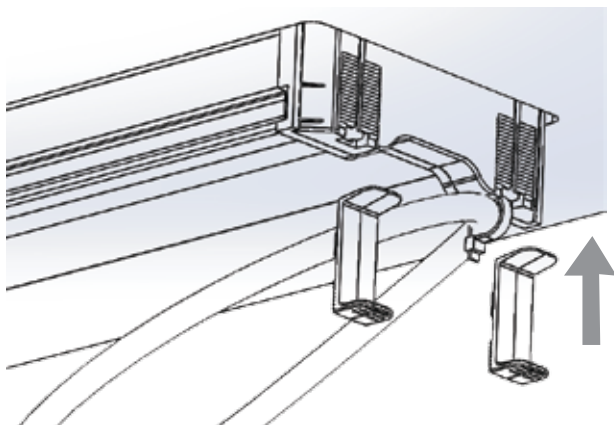
**3****4****5**